



OUTBACK  
MOTORCYCLES

## BMW R 12 G/S

### QUICK ASSEMBLY GUIDE | CRASH BARS

#### Tools Required

- ☐ Ratchet + Extension
- ☐ 6mm Allen Socket
- ☐ 8mm Allen Socket
- ☐ 10mm Allen Socket

- ☐ 13mm Wrench
- ☐ 17mm Wrench
- ☐ Blue Loctite (recommended)

Number	QTY	Specifications	Torque (NM)
<u>1</u>	2	M12 x 90mm Allen Partially Threaded Bolts	*
<u>2</u>	2	M12 Washers	-
<u>3</u>	2	39mm Spacers	-
<u>4</u>	1	M10 Flanged Through Bolt	*
<u>5</u>	1	77.5mm Stepped Spacer (Left Side)	-
<u>6</u>	1	32.5mm Stepped Spacer (Right Side)	-
<u>7</u>	2	M10 x 70mm Allen Head Partially Threaded	*
<u>8</u>	4	M10 Washers	-
<u>9</u>	1	M10 Nyloc Nut	-
<u>10</u>	2	18mm Spacers	-
<u>11</u>	1	M8 Flanged Through Bolt	<b>35</b>
<u>12</u>	1	171mm Spacer	-
<u>13</u>	1	M8 Nyloc Nut	-
<u>14</u>	2	M8 x 25mm Allen Head Bolts	*
<u>15</u>	3	M8 Washers	-

### STEP 1 (Left Side) :

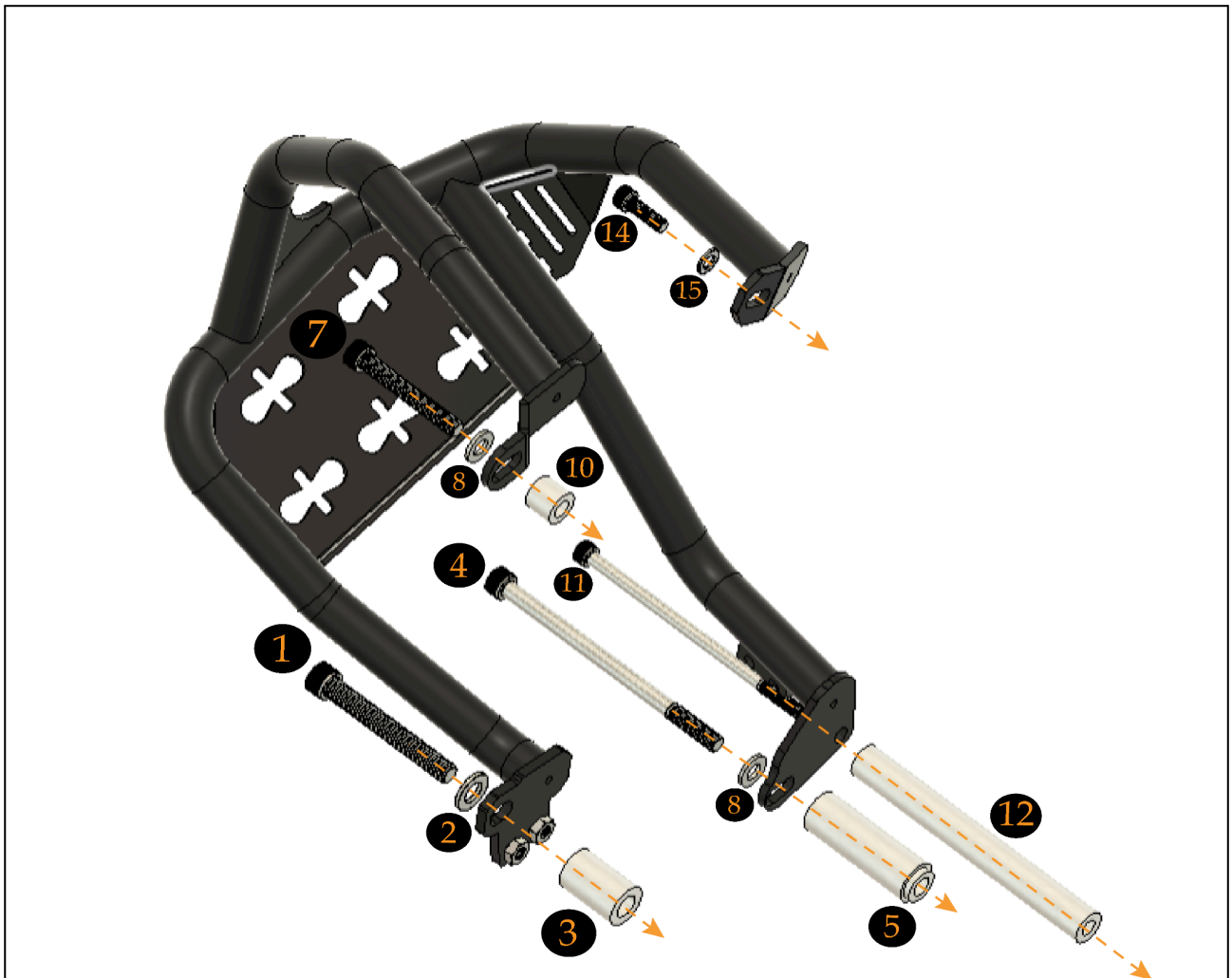

\* PLEASE REFER TO THE OWNER'S (OR SERVICE) MANUAL FOR **OEM** TORQUE SPECIFICATIONS.

## STEP 2 (Right Side) :



### \* Torque Disclaimer

Torque specs provided by Outback Motortek are for guidance only and may reference OEM data. Incorrect torque application from miscalibrated or improperly stored torque wrenches (which can drift by up to 20% within 12 months) may cause broken studs or mounting failures. Always return torque wrenches to 0 ft-lbs when storing, and use blue Loctite (medium strength) on all fasteners to help prevent loosening. Outback Motortek is not responsible for damage or failures caused by mis-torquing or improper installation.